



## Statement

Resettable call point, with double poles change over contacts from N/C to N/O. The main function is to override the electrical locking/release devices in case of emergency. With Key to reset the switch.

The resettable call point comes with hinged front cover to prevent the unit from activating randomly. Lock/Unlock instructed plates to show the status of the switch and also with the optional LED version to indicate the direction of the call point.

## Specifications

Dimensions: 87x91x53 mm  
 LED indicator (Optional)  
 Switch rating: 5A/125/250 VAC  
 Switch: Double pole

## Dimension

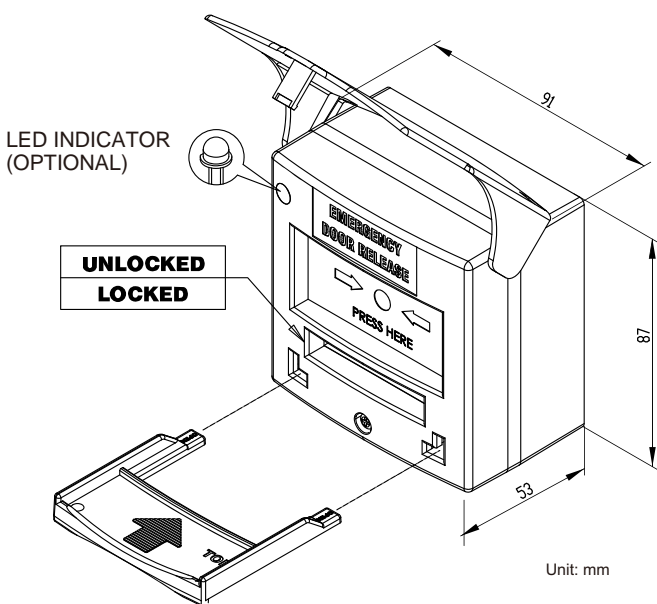

## Application

(CP-32\_LED Series)

